

08 SIMBA® GAS



Live out **loud.**



There's a whole world out there just waiting for you. A world filled with adventure and excitement. All you need is the 2008 Simba Gas from Safari. It's filled with comfortable amenities and convenient touches. And, with a price that's not out of this world, it's easy to make Simba your own. Get ready to take on the world, one adventure at a time.

Hello, world!





WORLD-CLASS LUXURY.

The 2008 Simba focuses on luxury, comfort and choice, with an impressive lineup of eight floorplans. Three floorplans feature our exclusive PanaSuite™ full-wall slides, which create a roomy, uninterrupted space for a truly residential look and feel. We're also introducing a new floorplan, the 36DBD, with a half bath across from the kitchen and a full, private bath at the back of the coach. This year Simba's exterior has been revamped, too, with a stylish new front end cap design and exciting new vinyl graphics over full-body paint.



KEY LARGO INTERIOR WITH NEWPORT CHERRY, 33SFS

WORLD TRAVELER.

It's easy to get comfortable in the Simba's cockpit. There are recliner pilot and co-pilot seats, a dash workstation and a wood center console with recessed tray and two-tier cup holders. You can add optional power sunvisors, rear vision system, GPS navigation and a driver's side door. Let us entertain you with a CD player/radio with Sirius-ready compatibility and a 26" LCD stereo TV in the cockpit overhead.





A WORLD OF WONDERS.

Beautiful Corian® solid surface countertops, a large double-door refrigerator and a convection microwave await you in the spacious Simba kitchen. You'll have plenty of room for utensils and supplies with all the beautiful cabinets. For the ultimate in convenience, you can add the optional washer/dryer combination and the central vacuum system.



KEY LARGO INTERIOR WITH NEWPORT CHERRY, 33SFS

A WORLD OF DIFFERENCE.

A good night’s sleep makes all the difference. And that’s exactly what you’ll get on Simba’s queen-size bed. Before calling it a night, wind down with some TV — a 20” television comes standard. And, there are exterior hook-ups for DSS Dish and cable, as well as a digital satellite system prep.



ASSISTANCE
SALES • TECH • ROADSIDE



WE’RE HERE. ANYTIME, EVERY TIME.

- Reach us anytime — literally — via our live customer support line.
- Drive in to one of our 350 Service Centers.
- Enjoy the first year free when you enroll in our Owner Advantage Roadside Assistance Program.
- See where it all begins with a tour of one of our facilities in Indiana or Oregon. Call 1-800-650-7337 or 1-800-634-0855 to find out more.

SIMBA GAS o8 WOODS & CONSTRUCTION

Newport Cherry



Champagne Select



BEYOND GREAT LOOKS.

Beautiful, raised panel cabinets add richness and sophistication to Simba's interior.

Shown here in the spacious bathroom, these cabinets are built to last with special features like heavy-duty bearing drawer glides, wood cabinet drawer boxes and toe kicks on base cabinets. Satin nickel hardware adds flair, and matches perfectly with the satin nickel lavatory faucet and bath accessories.

www.safarimotorcoaches.com



SIMBA GAS 08 FABRICS & EXTERIOR COLORS

KEY LARGO



BENTLEY



COPPER MINE



COLOR YOUR WORLD.

Safari coaches have a look that's all their own. Vibrant exterior colors and eye-catching graphics coordinate perfectly with the interior's playful patterns. Choose the combination that calls to you, and create the perfect backdrop for all your adventures.

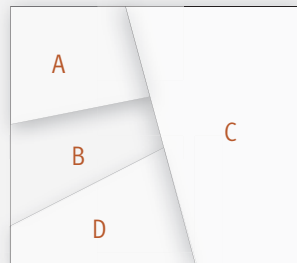

- A. BEDSPREAD
- B. SOFA
- C. DINETTE
- D. CARPET

MANUFACTURED IN, NOT ADDED ON.

For added protection against stains, soil repellent is applied to virtually all upholstery fabric during the finishing process for superior coverage.*

*Brand and application of upholstery fabric protection may vary depending on date recreational vehicle was manufactured.

BETTER
STAIN
PROTECTION



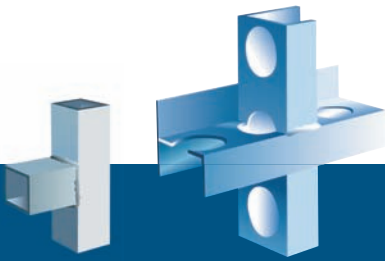

Aluminum
(Butt-Welded)

Alumaframe®
(C-Channel)

The Strength of Alumaframe®

Thanks to our Alumaframe® Superstructure, your Safari coach is built to take on anything the road can dish out. We revolutionized the industry by replacing outdated tubular aluminum construction with our exclusive system of aluminum C-Channel crossmembers. These run the full length of the coach, with double-welded intersections for superior strength. This makes your Safari lighter and sturdier than other coaches and gives you reliability you can count on down the road.



SLIDE-OUT CONSTRUCTION:

When you purchase a Safari coach, you can be sure the slide-out boxes are some of the strongest and most reliable you'll find anywhere. They feature our exclusive multi-layer construction to give you maximum insulation and to reduce the chance of warping, twisting or shifting.

9-Layer Roof (top to bottom)

- One-piece peaked fiberglass roof
- Luaun backing
- Thick, tapered bead foam insulation
- Aluminum double I-beam superstructure filled with fiberglass insulation
- Vapor barrier
- Structure foam: thermal insulative barrier
- 1/2" bead foam insulation
- Foam padding for extra insulation
- Padded vinyl ceiling

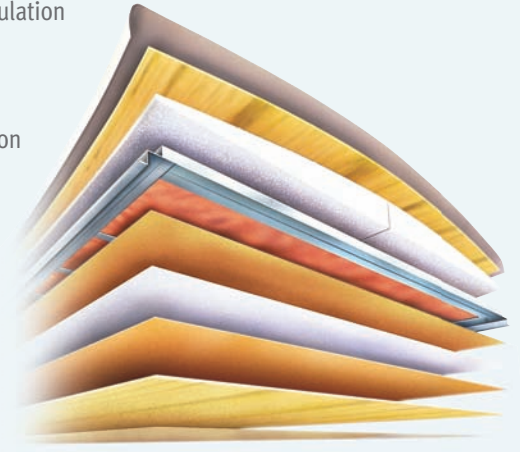

5-Layer Sidewall (left to right)

- Smooth gel coat fiberglass
- Interlocking C-Channel filled with 1-1/2" fiberglass insulation bonded in place so it doesn't sag or leave spaces uninsulated
- Vapor barrier
- Bead foam adds comfort, saves energy and provides a thermal insulative barrier
- Interior paneling

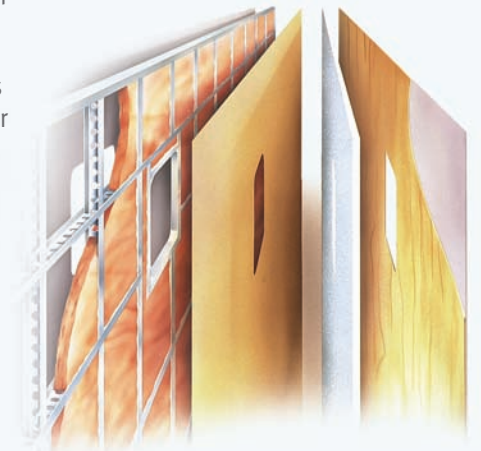

4-Layer Floor (top to bottom)

- Structurwood™
- Blue foam insulation
- 1-1/2" aluminum tube
- Three-ply poly underbelly

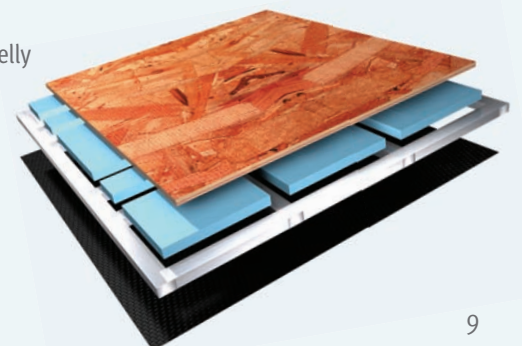

SIMBA GAS 08 FLOORPLANS

TILE 

CARPET 

30PDD

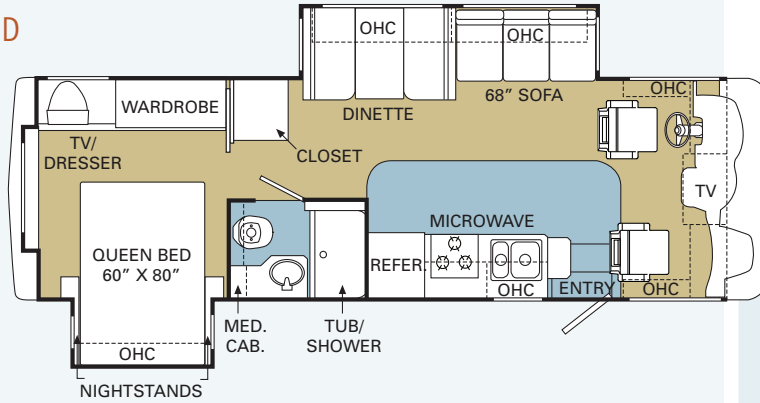

EXCLUSIVE HYDRAULIC

FULL-WALL SLIDE

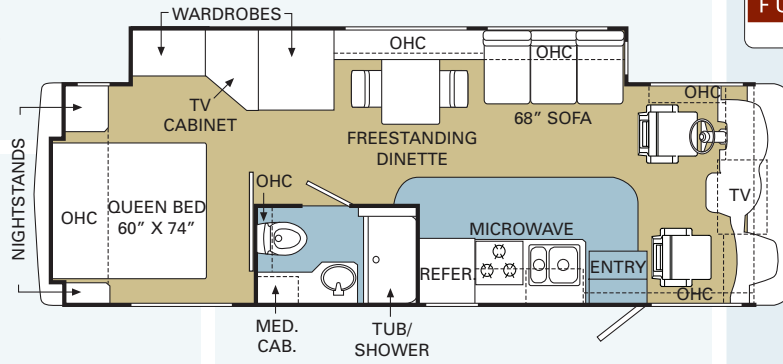

30SFS



EXCLUSIVE HYDRAULIC

FULL-WALL SLIDE

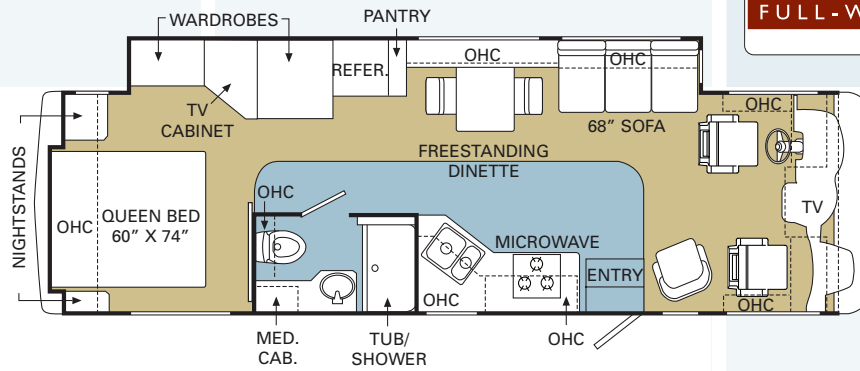
33SFS



34SBD

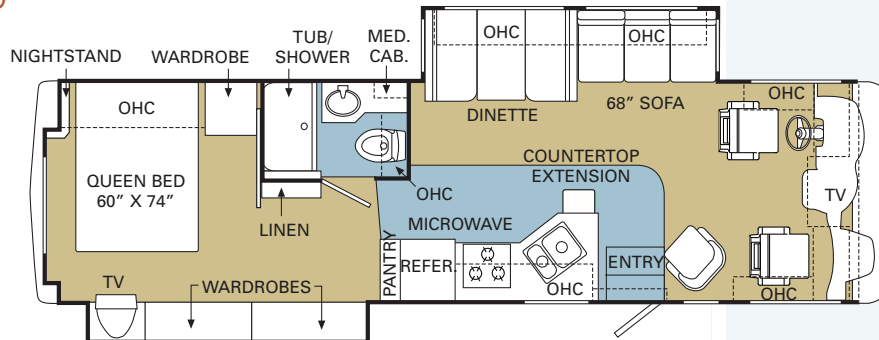

EXCLUSIVE HYDRAULIC

FULL-WALL SLIDE

PANA suite

35SFD

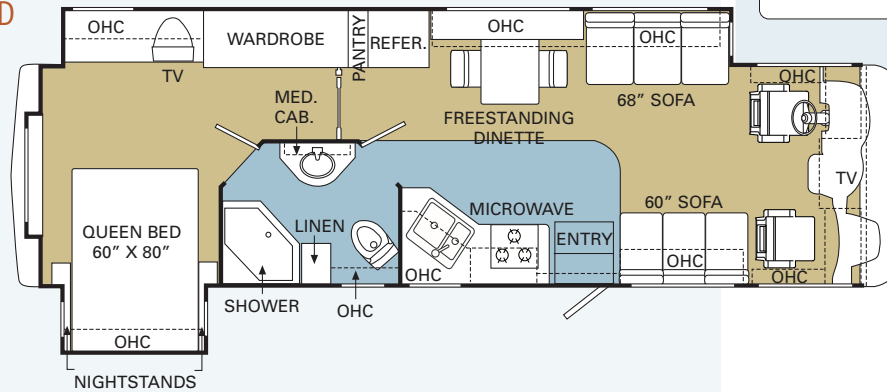

36DBD

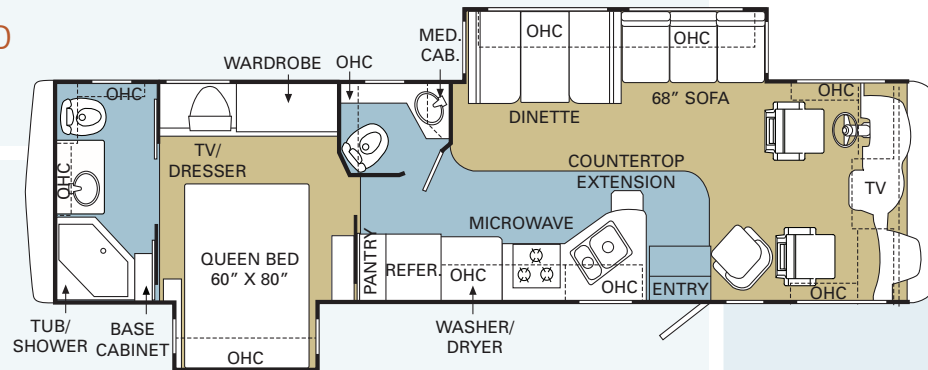

36PCT

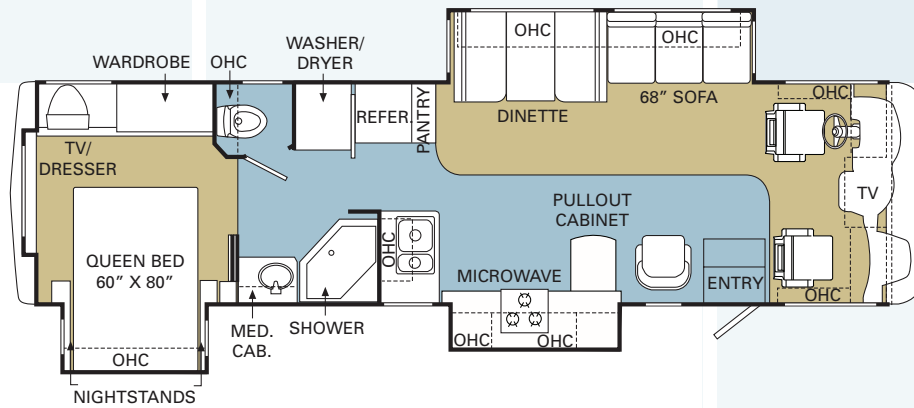

37PCT

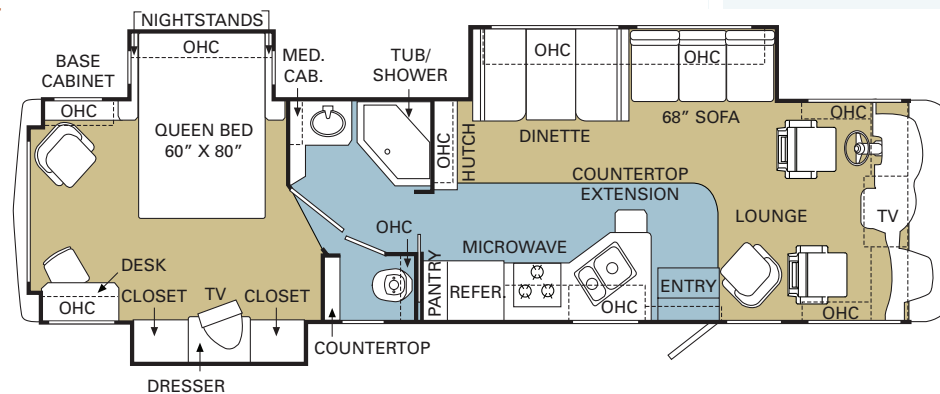

SIMBA GAS 08 FEATURES & OPTIONS

BODY CONSTRUCTION

- Alumaframe® Superstructure
- Steel Cage Cockpit Construction
- Smooth Gel Coat Fiberglass Exterior Walls
- Front Molded Fiberglass Caps
- Panaview™ 1-Piece Front Windshield
- Large Chrome Front Grille
- Rear Cap with Automotive Style Taillights
- 84" Interior Height
- One-Piece Interior Engine Cover
- Power Heated Remote Exterior Mirrors
- Metal Fuel Door with Lock
- 30" Deep Bedroom Slide-Out Houses (30PDD, 35SFD, 36DBD, 36PCT)
- One-Piece Polyethylene Pass-Through Storage Compartment
- Side-Hinged Baggage Doors
- Single Stage Full-Body Paint with Vinyl Graphics
- Rear Ladder
- Undercoating

OPTIONS

- Film Front Protective Mask
- Standard Run Savings Package: Film Front Protection Mask, Power Sunvisors, Hardwood Raised Panel Doors on Refrigerator, Single 15M BTU Air Conditioner with Heat Pump, Patio Awning (30PDD, 30SFS)
- Standard Run Savings Package: Film Front Protection Mask, Power Sunvisors, Hardwood Raised Panel Doors on Refrigerator, 50 Amp Energy Management System, Patio Awning (N/A: 30PDD, 30SFS)

FORD CHASSIS/ENGINE/SUSPENSION — 20,500 LBS. (30PDD, 30SFS)

- 6.8L 3-Valve V-10 Gasoline Engine with Electronic Fuel Injection
- Engine Displacement: 6.8 Liters 415 Cu. In.
- Power: 362HP
- Torque: 457 lbs./ft.
- TorqShift 5-Speed Automatic Overdrive Transmission with Tow/Haul Mode
- Transmission Oil Temperature Gauge
- Fuel Tank Capacity 75 Gallon
- 130 Amp Alternator
- Rear Axle Ratio: 5.38:1
- Radial Tires: 245/70R x 19.5F
- Stainless Steel Wheel Liners
- Leaf Spring Suspension
- Front and Rear Disc, 4-Wheel Anti-Lock Brakes
- Heavy-Duty Front Track Bar with Bilstein® Shock Absorbers
- Prewire for Supplemental Braking System
- 5,000 Lb. Hitch Receiver with Dual Connector 4-Pin or 7-Pin (Hidden Hitch)
- SmartStructure II

WORKHORSE CHASSIS/ENGINE/SUSPENSION — 20,700 LBS. (30PDD, 30SFS)

- 8.1L V-8 Gasoline Engine with Electronic Fuel Injection
- Engine Displacement: 8.1 Liters 496 Cu. In.
- Power: 340HP
- Torque: 455 lbs./ft.
- 6-Speed Automatic Transmission with Overdrive
- Fuel Tank Capacity 75 Gallon
- 145 Amp Alternator
- Rear Axle Ratio: 5.13:1
- Radial Tires: 245/70R x 19.5F
- Stainless Steel Wheel Liner
- Leaf Spring Suspension
- ABS Brake System
- Prewire for Supplemental Braking System
- 5,000 Lb. Hitch Receiver with Dual Connector 4-Pin or 7-Pin
- Smartstructure II

FORD CHASSIS/ENGINE/SUSPENSION — 22,000 LBS. (N/A: 30PDD, 30SFS, 33SFS)

- 6.8L 3-Valve V-10 Gasoline Engine with Electronic Fuel Injection
- Engine Displacement: 6.8 Liters 415 Cu. In.
- Power: 362HP
- Torque: 457 lbs./ft.
- TorqShift 5-Speed Automatic Overdrive Transmission with Tow/Haul Mode
- Transmission Oil Temperature Gauge
- Fuel Tank Capacity 75 Gallon
- 130 Amp Alternator
- Rear Axle Ratio: 5.38:1
- Radial Tires: 235/80R/22.5G
- Wheel/Rims Polished Aluminum Wheels
- Leaf Spring Suspension
- Front and Rear Disc, 4-Wheel Anti-Lock Brakes
- Heavy-Duty Front Track Bar with Bilstein® Shock Absorbers
- Fully Automatic Hydraulic Leveling System
- Prewire for Supplemental Braking System
- 5,000 Lb. Hitch Receiver with Dual Connector 4-Pin or 7-Pin
- Smartstructure II

WORKHORSE CHASSIS/ENGINE/SUSPENSION — 22,000 LBS. (N/A: 30PDD, 30SFS)

- 8.1L V-8 Gasoline Engine with Electronic Fuel Injection
- Engine Displacement: 8.1 Liters/496 Cu. In.
- Power: 340HP
- Torque: 455 lbs./ft.
- 6-Speed Automatic Transmission with Overdrive
- Fuel Tank Capacity 75 Gallon
- 145 Amp Alternator
- Rear Axle Ratio: 5.86:1
- Radial Tires: 235/80R/22.5G
- Stainless Steel Wheel Liners
- Leaf Spring Suspension
- ABS Brake System
- Fully Automatic Hydraulic Leveling System
- Prewire for Supplemental Braking System
- 5,000 Lb. Hitch Receiver with Dual Connector 4-Pin or 7-Pin
- Smartstructure II

SIMBA GAS 08 FEATURES & OPTIONS

COCKPIT

- Fiberglass Automotive Dash with New Roman Bronze Color Instrument Panel
- CD Player/Radio with Sirius-Ready Compatibility, Weather Band and Six Speakers
- Multi-Positioned Sunvisors
- Rear Vision System Prep
- Wood Center Console on Engine Cover, Recessed Tray with Rubber Mat, and Plastic Two-Tier Cup Holders

- Leatherette Pilot and Co-Pilot Cockpit Recliner Seats
- Carpeted Driver and Passenger Floor Mats
- Dash Workstation

- Single Camera Rear Vision System with Audio and Adjustable Camera
- 3- Camera Rear Vision System with Audio and Adjustable Center Camera
- Power Sunvisors (Required Option)
- Interior Solar Privacy Sunscreens
- CB Radio Prep
- Driver's Side Door with Electric Window

OPTIONS

- Sirius Radio Satellite System (Requires Subscription)
- GPS System High-Speed DVD Navigation System (Requires Rear Vision System Selection)

APPLIANCES AND ACCESSORIES

- Large Double-Door Refrigerator
- High-Output 3-Burner Cooktop without Oven
- Bi-Fold Range Cover
- Spacesaver Convection Microwave with Touch Control
- 26" LCD Stereo Color TV with Remote Control in Cockpit Overhead
- 20" Color TV with Remote Control in Bedroom Curbside:
 - Exterior Hook-Ups for DSS Dish, Cable, 110V Outlet, with Hatch Door to Exterior Digital Satellite System Prep

OPTIONS

- Large Double-Door Refrigerator with Ice Maker
- Large Double-Door Refrigerator with Ice Maker 10 Cu. Ft.
- Large Four-Door Refrigerator with Ice Maker (N/A with Pantry) (N/A: 30PDD, 30SFS, 33SFS)
- High-Output Three-Burner Range with Oven
- Washer/Dryer Prep (36DBD, 36PCT)

- Combination Washer/Dryer (Requires Washer/Dryer Prep Option) (36DBD, 36PCT)
- Central Vacuum System
- Front Living Room Area DVD Player
- Bedroom DVD Player
- Exterior Entertainment Center, CD Player/Radio with Two Speakers

INTERIOR

- Raised Panel Cabinet Doors
- Black ABS Refrigerator Insert
- Heavy-Duty Ball Bearing Drawer Guides
- Wood Cabinet Drawer Boxes
- Solid Surface Kitchen Countertop with Solid Surface Edge Treatment and Solid Surface Backsplash
- Kitchen Countertop Extension with Two Drawers below and 110V Outlet under Extension (34SBD, 36DBD, 37PCT)
- Large Kitchen Countertop Pullout Extension with Drawers Below (36PCT)
- All Other Countertops Laminate

- Kitchen Pantry next to Refrigerator with Full-Height Wire Roll-Out Storage (N/A with Four-Door Refrigerator Option) (N/A: 30PDD, 30SFS)
- Carpeting with Pad in Living Area and Bedroom
- Wood Slide-Out Fascia with Black Diamond Fabric Inserts in Fascia Legs
- Satin Nickel Cabinetry Hardware and Bath Accessories
- Hardwood Framed Pocket Doors with Flat Panel Insert (N/A: 35SFD)
- Blackout Day/Night Pleated Shades in Living Area and in Bedroom
- Soil Repellant on Fabric, Teflon® Fabric Protection

OPTIONS

- Decors: Copper Mine, Bentley and Key Largo
- Wood Choice: Newport Cherry, Champagne Select
- Hardwood Raised Panel Doors on Refrigerator IPO Black ABS Refrigerator Insert

FURNITURE

- Queen Bed with Nightstands
- Arched Back Wood Booth Dinette with Side-Sliding Dinette Tabletop (N/A: 30SFS, 33SFS, 35SFD)
- Freestanding Dinette with Two Freestanding Chairs and Two Folding Chairs (30SFS, 33SFS, 35SFD)
- Leatherette Swivel Rocker Barrel Chair (N/A: 30PDD, 30SFS, 35SFD)
- Fabric Swivel Rocker Barrel Chair with Desk and Chair in Bedroom (37PCT)

Roadside:

- Fabric Easy Bed Sofa

Curbside:

- Fabric Easy Bed Sofa (35SFD)

OPTIONS

- Two Fabric Swivel Rocker Barrel Chairs with Center Lift-Up Table IPO Desk and Desk Chair Bedroom (37PCT)
- Hallway Bunks with Bottom Drawers, 20" LCD TV, AV Game Plate Built into Outside of Bath Wall, and Bunk Ladder (34SBD)
- Freestanding Dinette with Two Freestanding Chairs and Two Folding Chairs (34SBD, 36DBD, 36PCT, 37PCT)

Roadside:

- Fabric Hide-A-Bed Sofa
- Fabric Hide-A-Bed Sofa with Air Mattress
- Leatherette Hide-A-Bed Sofa with Air Mattress
- Leatherette Ensemble Booth Dinette; Includes Leatherette Hide-A-Bed Sofa Selection with Air Mattress (34SBD, 36DBD, 36PCT, 37PCT)

Curbside:

- Leatherette Easy Bed Sofa IPO Fabric
- Easy Bed Sofa (35SFD)
- One Leatherette Euro-Recliner Chair with Ottoman, with Wall-Mounted Table IPO Sofa (35SFD)
- Leatherette Euro-Recliner Chair with Ottoman IPO Fabric Swivel Rocker Barrel Chair (N/A: 30PDD, 30SFS, 35SFD)

SIMBA GAS 08 FEATURES & OPTIONS

ELECTRICAL SYSTEMS AND LIGHTS

- 30 Amp 120V Distribution Panel and Cord (30PDD, 30SFS)
- 50 Amp 120V Distribution Panel and Cord (N/A: 30PDD, 30SFS)
- 60 Amp Electronic 12V Power Converter
- Onan® 4.0 kW Gas Generator (30PDD, 30SFS)
- Onan® 5.5 kW Gas Generator
- Two 6V House Batteries
- Battery Disconnect Switches
- Exterior Power Entry Step with Light
- Water Pump Switch in Service Bay Area and Convenience Center
- Lights in Outside Storage Compartments
- Underhood Utility Light
- Two Recessed Ceiling Map Lights above Cockpit Seats
- Hallway Convenience Center
- Three Recessed Ceiling Lights above Countertop Work Area Kitchen
- Decorative Satin Nickel Lighting

OPTIONS

- 50 Amp Energy Management System

PLUMBING AND LP SYSTEMS

- Hi-Rise Kitchen Faucet with Soap Dispenser
- Central Water Filtration System
- Satin Nickel Bath Lavatory Faucet
- Demand Water System and Water Pump
- 6-Gallon LP Gas/Electric Water Heater with Electronic Ignition, DSI
- Winterization Valving System
- Water Heater Bypass Valve
- China Toilet with Sprayer
- No-Fuss Flush Holding Tank Rinsing System
- Insulated Systems Compartment with Easy Access to Hook-Up
- Shower inside Wet Bay with Hot/Cold Water; Shower Head with Shut-Off
- Soap Dispenser inside Utility Bay
- Gravity and Pressurized Water Fill (N/A: 35SFD)
- Contained Storage Area for Sewer Hose
- Shower Faucet with Shower Hose and Head with Shut-Off

OPTIONS

- RV Sani-Con 2 System, Holding Tank Flush System with Hanging Bracket for Hose
- 10-Gallon LP Gas/Electric Water Heater with Electronic Ignition, DSI IPO 6-Gallon LP Gas/Electric Water Heater
- Bathtub Option IPO Shower; ABS Surround with New Shower Doors

HEATING, VENTS AND AIR CONDITIONING

- Dual 13.5M BTU Air Conditioner with Ducted Air and Wall Thermostats (N/A: 30PDD, 30SFS)
- Single 13.5M BTU Air Conditioner with Ducted Air and Wall Thermostats (30PDD, 30SFS)
- 31M BTU Electronic Ignition Furnace (30PDD, 30SFS)
- 35M BTU Electronic Ignition Furnace (N/A: 30PDD, 30SFS)
- 12V Roof Vent in Kitchen and Bath

OPTIONS

- Dual 15M BTU Air Conditioner with Heat Pumps IPO 13.5 Brisk Air (N/A: 30PDD, 30SFS)
- Single 15M BTU Air Conditioner with Heat Pump IPO 13.5 Brisk Air (30PDD, 30SFS)
- Kitchen Powered Attic Fan with Wall Control of Automatic Dome and Fan Power
- Bath Powered Attic Fan with Wall Control of Automatic Dome and Fan Power
- 12V Heater in Wet Bay, Heat Pad on Fresh Tank

WINDOWS, DOORS AND AWNINGS

- Radius Flush-Mounted Dual Pane Safety Glass Dark Tinted Windows
- Opera Window at Barrel Chair Location
- Rear Wall Bedroom Window (N/A: 30SFS, 33SFS, 36DBD)
- Bathroom Window (N/A: 30PDD, 30SFS, 33SFS, 34SBD)
- Radius Entrance Door with Clear Glass, Roller Shade, Screen Door and Anti-Skid Steps
- Topper Slide-Out Awnings Living Area and Bedroom
- Protecta Glaze Tinted Plexiglas® Skylight in Bathroom
- Awning Rail

OPTIONS

- Patio Awning
- Eclipse Poly-Weave Automatic Patio Awning
- Poly-Weave Window Awnings Living Area Slide-Out House Windows
- Bedroom Skylight with Decorative Wood Frame and Shade (37PCT)
- Poly-Weave Side Window Awning Bedroom (N/A: 34SBD, 35SFD, 37PCT)

SAFETY

- Fire Extinguisher
- Deadbolt Lock on Entrance Door
- 120V GFI Protected Circuit, Kitchen, Bath and Exterior
- LP Gas Detector
- Smoke Detector
- Carbon Monoxide Detector
- Pilot and Co-Pilot Three-Point Seatbelts
- Third Brake Safety Light
- Egress Window(s)

Due to continuous product improvement, please see the website for the latest in standards and options, specifications, and technical data. Go to www.safarimotorcoaches.com.

SIMBA GAS 08 WEIGHTS & MEASUREMENTS

	30PDD	30SFS	33SFS	34SBD	35SFD	36DBD	36PCT	37PCT
Weights (Ford 20,500 Lb. Chassis) * (Lbs.)								
Gross Vehicle Weight Rating	20,500	20,500	N/A	N/A	N/A	N/A	N/A	N/A
Gross Combined Weight Rating	25,500	25,500	N/A	N/A	N/A	N/A	N/A	N/A
Front Gross Axle Weight Rating	7,000	7,000	N/A	N/A	N/A	N/A	N/A	N/A
Rear Gross Axle Weight Rating	13,500	13,500	N/A	N/A	N/A	N/A	N/A	N/A
Weights (Workhorse 20,700 Lb. Chassis) * (Lbs.)								
Gross Vehicle Weight Rating	20,700	20,700	N/A	N/A	N/A	N/A	N/A	N/A
Gross Combined Weight Rating	25,700	25,700	N/A	N/A	N/A	N/A	N/A	N/A
Front Gross Axle Weight Rating	7,500	7,500	N/A	N/A	N/A	N/A	N/A	N/A
Rear Gross Axle Weight Rating	13,500	13,500	N/A	N/A	N/A	N/A	N/A	N/A
Weights (Ford 22,000 Lb. Chassis) * (Lbs.)								
Gross Vehicle Weight Rating	N/A	N/A	N/A	22,000	22,000	22,000	22,000	22,000
Gross Combined Weight Rating	N/A	N/A	N/A	26,000	26,000	26,000	26,000	26,000
Front Gross Axle Weight Rating	N/A	N/A	N/A	7,500	7,500	7,500	7,500	7,500
Rear Gross Axle Weight Rating	N/A	N/A	N/A	14,500	14,500	14,500	14,500	14,500
Weights (Workhorse 22,000 Lb. Chassis) * (Lbs.)								
Gross Vehicle Weight Rating	N/A	N/A	22,000	22,000	22,000	22,000	22,000	22,000
Gross Combined Weight Rating	N/A	N/A	26,000	26,000	26,000	26,000	26,000	26,000
Front Gross Axle Weight Rating	N/A	N/A	8,000	8,000	8,000	8,000	8,000	8,000
Rear Gross Axle Weight Rating	N/A	N/A	14,500	14,500	14,500	14,500	14,500	14,500
Measurements								
Wheelbase	190"	190"	228"	228"	228"	242"	242"	242"
Overall Length	TBD	TBD	TBD	TBD	TBD	TBD	TBD	TBD
Overall Height, Including A/C	12' 6"	12' 6"	12' 9"	12' 9"	12' 9"	12' 9"	12' 9"	12' 9"
Interior Height	84"	84"	84"	84"	84"	84"	84"	84"
Interior Width	94.5"	94.5"	94.5"	94.5"	94.5"	94.5"	94.5"	94.5"
Exterior Width	100.5"	100.5"	100.5"	100.5"	100.5"	100.5"	100.5"	100.5"
Tank Capacities ** (Gal.)								
Water Heater	6	6	6	6	6	6	6	6
Gray Tank (Ford/Workhorse)	54	54	54	57	57	40/41	60	57
Black Tank (Ford/Workhorse)	45	45	45	42	42	40/41	40	42
Fresh Tank	60	60	60	60	60	60	60	60
LP Tank ***	20	20	20	20	20	20	24	20

* Towing capacity is limited by GCWR; your vehicle's towing capacity is the difference between the GCWR and the actual vehicle weight, including all water, fuel, passengers and cargo. Your towed vehicle should be equipped with auxiliary brakes if the weight of the towed vehicle exceeds 1,000 lbs. Consult your owner's manual for further towing information.

** All tank capacities are estimated based upon calculations provided by the tank manufacturers and represent approximate capacities. The actual "usable capacity" may be greater or less than the estimated capacities based upon fabrication and installation of the tanks.

*** Actual filled LP capacity is 80% of listing due to safety shut-off required on tank.

The actual overall length of the recreational vehicle may differ from that indicated in the brochure due to variances in the manufacturing process and/or installed components. The actual length may be greater or less than that indicated. Due to the large variety of options and floorplan arrangements available to our customers, actual weights for each unit can differ significantly. Safari provides a weight sticker on each unit we produce which includes that unit's tank capacities and approximate weight. Consult your local Safari dealer for unit availability and further information. The information printed in this brochure reflects product design, fabrication, and component parts at the date of printing. The manufacturer reserves the right, at any time, to make changes in product design or material or component specifications as its sole option, without notice. This includes the substitution of components of a different brand or trade name which will result in comparable performance. All information printed in this brochure is subject to change after the date of printing. Some features shown or mentioned in this brochure are optional and may only be available in selected floorplans. Photographs may show props or decorations that are not standard equipment on Safari models. Safari, the Safari logo and its design, are registered trademarks. All other products and company names are trademarks and/or registered trademarks of their respective holders. While the color of the motorhome's exterior and the interior fabrics depicted in this sales brochure are fair and reasonable depictions, the colors depicted may not be an exact match of the actual colors because of the variances in photo-processing and variances caused by inserting the photographs within the sales brochure. Due to product improvements, changes during the model year and/or transcription errors that may occur, information represented within this brochure may not be accurate at the time of your purchase. If certain information is significant to your purchasing decision, please confirm the information with your dealer prior to submitting your order. Component part and appliance manufacturers issue limited warranties covering those portions of the recreational vehicle not covered by the Limited Warranties issued by Monaco Coach Corporation. To learn which specific component parts and appliances are excluded from the Limited Warranties issued by Monaco Coach Corporation, please contact your selling dealership or Monaco Coach Corporation directly, or review the warranty packet inside the recreational vehicle.

BEING DIFFERENT MAKES ALL THE DIFFERENCE.

At Monaco Coach Corporation, we always strive to be the best. And that means thinking outside the box. Giving you more of what you want in an RV. Like our exclusive Roadmaster chassis. PanaSuite™ full-wall slides. And programs like Monaco Financial Services and 24/7 roadside assistance. No other manufacturer can match Monaco's offerings. No one even comes close. Why not discover the difference for yourself? Visit www.monacodifferent.com.

Kay
KAY TOOLSON,
CEO



"No other manufacturer can match Monaco's offerings. No one even comes close."



www.safarimotorcoaches.com

91320 Coburg Industrial Way, Coburg, OR 97408

1.800.458.8735

WARRANTIES

12 MONTH/24,000 MILE
basic limited warranty

5 YEAR/50,000 MILE limited warranty on
aluminum or steel frame structure of
sidewall, roof, front and rear cap

Applies to certain models. See owner's
manual for complete details.